

THERMOPLAN B&W3 CTM2 + UNDERCOUNTER FRIDGE

Quality at the touch of a button.
World-class milk. Swiss made modularity.

FEATURES + BENEFITS

- Made to last – the Black&White 3 is built to last – durable aluminium grinders, ceramic burrs and a solid stainless steel chassis deliver durability and reliability. Clever modularity also allows front-end module access, minimising down time.
- Versatile and customisable – a wide range of popular drinks and a customisable LED colour touch screen means the B&W3 can help you deliver the complete coffee offer.
- Quality drinks every time – patented milk technology and the finest quality components guarantee that every B&W coffee will be as incredible as the last. This unique milk system prepares creamy, firm and consistent milk foam without the requirement for an annual Pressure Vessel Inspection.
- Key features – automated cleaning, 13amp power supply, Pressure Vessel Inspection not required, exchangeable modular design and undercounter fridge.



KEY STATISTICS

| **Product:** Coffee. Tea. Milk

| **Power (watts):** 2800

| **Milk:** Auto

Product code: 9992

THERMOPLAN
B&W3 CTM2 +
UNDERCOUNTER FRIDGE

Quality at the touch of a button.
World-class milk. Swiss made modularity.

CAPACITY AT PEAK



Medium
volume

CAPACITY PER DAY







Medium
volume

RECOMMENDED PRODUCTS

Quarterly Cleaning Pack
Product code: CLESCH0591

LEC Fridge
Product code: 9171
Dimensions w x d x h (mm):
470 x 604 x 500
Power (watts): 13A standard
3-pin sockets
Important: Ventilation
grill required

Water connection	2-4 BAR isolated 15mm feed, 3/4" BSP screw fitting	
Filter type	Brita Purity 600/1200 C50	
Waste	1.5" downpipe to P-trap, minimum length 8"	
Power (watts)	2800	
Power requirements	1 x 230Vac 13A standard 3-pin socket	
Breaker	B	
Drinks dispensed simultaneously	N/A	
Milk option	Auto	
Product	Coffee. Tea. Milk	
Weight (kg)	55	
Dimensions w x d x h (mm)	350 x 600 x 730	

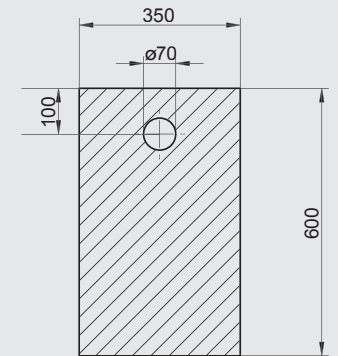
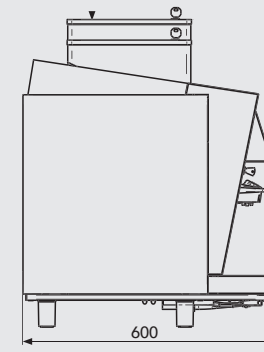
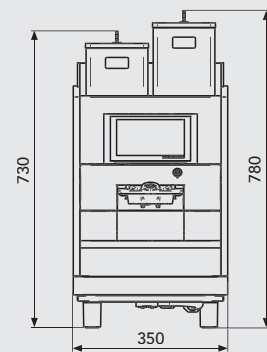

Hole is required through the counter